



VASONA MANAGEMENT

St Moritz 1531 Detroit Ave. Concord 94520

tel: 925.685.4142 fax: 924.685.5095 email: moritz.concord@vasonamanagement.com

OFFICE HOURS:

8:30-5:30 M-F

Weekends by appt.

FEATURES:

- Unfurnished
- Gated Community
- Laundry Facility
- Covered Parking
- Swimming Pool

BEDS	BATHS	SQUARE FEET
1	1	720
2	1	825

Welcome to St. Moritz Apartments, one of Concord's finest apartment communities. Each apartment home features a patio or balcony for enjoying the serene setting. Very conveniently located near shopping centers, schools with easy access to freeways and BART. The spacious one and two bedroom floor plans include generous closet space and fully equipped kitchens with dishwasher, disposal and electric stoves. St. Moritz Apartments is the ultimate in affordable luxury.

ONE BEDROOM

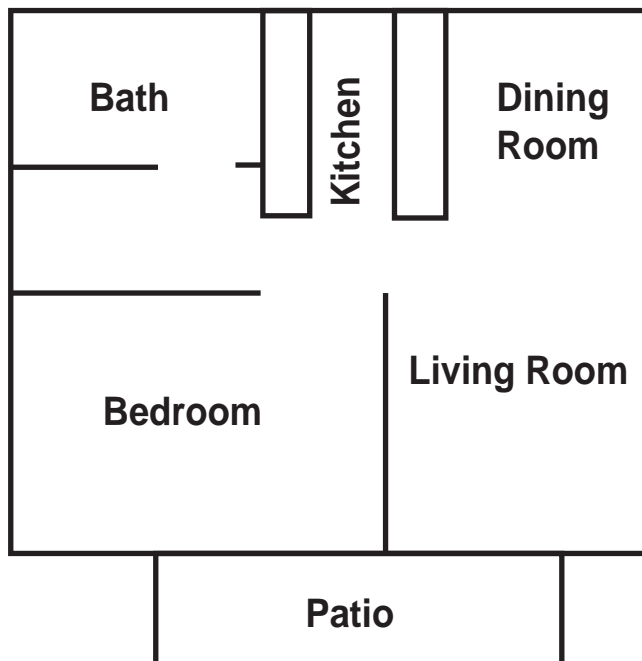

TWO BEDROOM

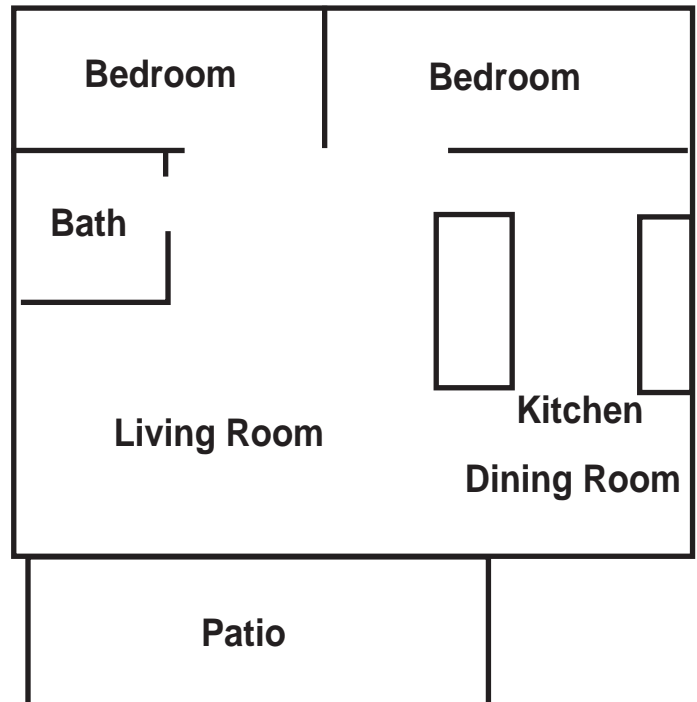



VASONA MANAGEMENT

St Moritz 1531 Detroit Ave. Concord 94520

tel: 925.685.4142 • fax: 924.685.5095 • stmoritz.concord@vasona.com

From San Jose:

Take 680 North towards Sacramento.

Take CA-242 North to Clayton Road exit towards Concord.

Turn right on Detroit Avenue.

We're on the right side at 1531 Detroit Ave.

From San Francisco:

Take Hwy 101 North to 80 East towards Bay Bridge.

Take 580 East ramp towards Oakland then to 24 East to 680 North.

Take CA-242 North to Clayton Road exit towards Concord.

Turn right on Detroit Avenue.

We're on the right side at 1531 Detroit Avenue.

From Sacramento:

Take 80 West to 680 South towards Benicia/ San Jose.

Exit left on Willow Pass Road.

Right on Market Street then left on Clayton Road.

Right on Detroit Avenue.

We're on the right at 1531 Detroit Avenue.

