



VASONA MANAGEMENT

Adelaide Pines 1730 Adelaide St. Concord, Ca 94520

tel: 925.676.7577 • fax: 925.685.5096 • adelaide@vasonamanagement.com

OFFICE HOURS:

9:00 - 5:00 M-F Weekends by Apt.

FEATURES:

- New Tiled Entry
- New Vanities
- New Bathroom Tile
- Air Conditioning
- Pool
- Gated Community
- Dishwasher and Disposal
- Covered Parking

BEDS	BATHS	SQUARE FEET
1	1	828
2	1	828

Adelaide Pines is a quite Community, adjacent to another Vasona Community, City Walk Apartments. A complete renovation that raises your quality of apartment living in Concord. Everything is new, from the interiors to the exterior and landscaping. The location is perfectly centered for BART, freeways and the "Park-and-Shop" Mall.

ONE BEDROOM

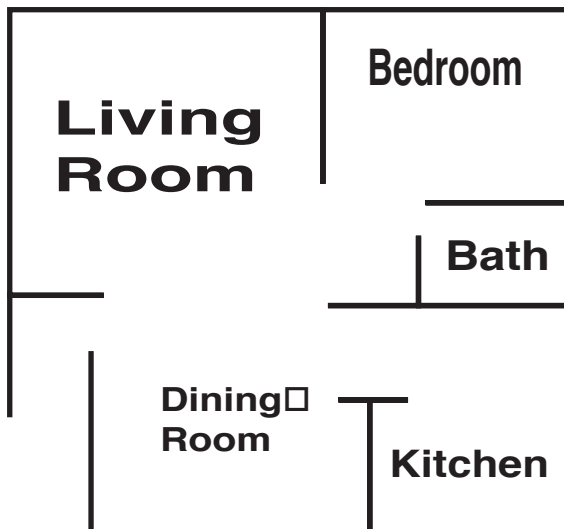

TWO BEDROOM

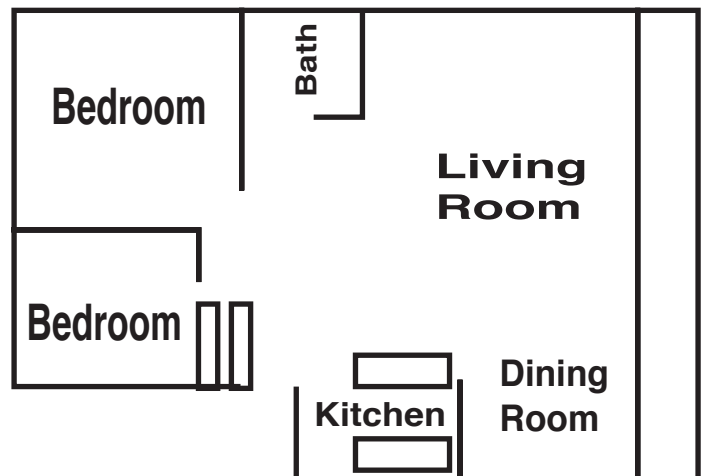



VASONA MANAGEMENT

From I-680

exit 242 to Clayton Road exit.

Go east to the corner of Clayton Road and Adelaide Street

look for the double tier fountain in front.

